



City of Napoleon Building Department

255 W. Riverview
 P.O. Box 151
 Napoleon, OH 43545
 Phone: (419) 592-4010
 Fax: (419) 599-8393
 Email:

Building

Permit Number: P-17-0325
 Expiration Date: 08/29/2018

dave spangler
 646 Beckham

Napoleon, OH 43545

Description:

\$25.00	Building - Garage and Shed over 200 SF (Detached)	1 Garage & Shed over 200SF x \$25.0000
---------	---	--

\$0.25	Ohio Board of Building Standards Fee 1%	\$25.0000 @ 1%
--------	---	----------------

Building Permit Info

Project Description:	Build 16X24 D post frame building with concrete floor
Construction Value:	\$8,000.00

 Authorizing Signature

 Date

CITY OF NAPOLEON GENERAL PERMIT APPLICATION

THIS APPLICATION IS FOR RESIDENTIAL CONSTRUCTION INCLUDING BUILDING, ELECTRICAL,
PLUMBING, MECHANICAL & REMODELING

DATE 8-29-17 JOB LOCATION 646 Beckham
 OWNER DAVID SPANGLER TELEPHONE # 419-438-2489
 OWNER ADDRESS 11649 County Road K
 CONTRACTOR DAVID SPANGLER CELL PHONE # _____
 DESCRIPTION OF WORK TO BE PERFORMED Build 16x24x10 post FRAME building w/CONCRETE floor
 ESTIMATED COMPLETION DATE 12-30-17 ESTIMATED COST 8000

Affected Floor Area (AFA): In existing structures, it is the area affected by the improvement, i.e. a new wall dividing a room (the AFA would be only the room and not all the rooms).

DESCRIPTION	FEE	TOTAL COST
BUILDING:		
<i>Decks</i>	\$25.00	\$
<i>Addition & Alterations</i> Square foot in (AFA) x \$0.05 = \$	+ \$25.00 =	\$
<i>Garage and Shed over 200 SF (Detached)</i>	\$25.00	\$ <u>25⁰⁰ x</u>
<i>Siding and/or Roofing</i>	\$25.00	\$
<i>Windows/Doors</i>	\$25.00	\$
ELECTRICAL:		
<i>Electrical</i> Circuits in (AFA) x \$3.00/Circuit = \$	+ \$25.00 =	\$
<i>Electrical Service Upgrade</i>	\$25.00	\$
MECHANICAL:		
<i>Water Heater</i>	\$25.00	\$
<i>Furnace and/or AC Replacement</i>	\$25.00	\$
PLUMBING:		
<i>Plumbing</i> Traps in (AFA) x \$3.00/Trap = \$	+ \$25.00 =	\$
TOTAL plus Ohio Board of Building Standards Fee 1%		\$ <u>125</u>

P.17-0325

TOTAL FEE: \$ 25.25

I FULLY UNDERSTAND THAT NO EXCAVATION, CONSTRUCTION OR STRUCTURAL ALTERATION, ELECTRICAL OR MECHANICAL INSTALLATION OR ALTERATION OF ANY BUILDING STRUCTURE, SIGN, OR PART THEREOF AND NO USE OF THE ABOVE SHALL BE UNDERTAKEN OR PERFORMED UNTIL THE PERMIT APPLIED FOR HEREIN HAS BEEN APPROVED AND ISSUED BY THE CITY OF NAPOLEON BUILDING/ZONING DEPARTMENT.

I hereby certify that I am the Owner of the named property, or that the proposed work is authorized by the Owner of record and that I have been authorized by the Owner to make this application as his/her authorized agent and I agree to conform to all applicable laws of the jurisdiction. In addition, if a permit for Work described in this application is issued, I certify that the code official or the code official's authorized representative shall have the authority to enter areas covered by such permit at any reasonable hour to enforce the provisions of the code(s) applicable to such permit.

I HEREBY ACKNOWLEDGE THAT I HAVE READ AND FULLY UNDERSTAND THE ABOVE LISTED INSTRUCTIONS.

SIGNATURE OF APPLICANT: [Signature] DATE: 8-29-17

PRINT NAME: DAVID SPANGLER

BATCH # 37354 CHECK # 10313 DATE 8-29-17

DAVID SPANGLER
11649 COUNTY ROAD K
Napoleon, Ohio 43545
419-438-2489

Site
646 Beckham
Napoleon, Ohio 43545

16x4x10' Pole BARN
8' Center Post
4' OC TRUSSES 4/12 PITCH
2' Side Girts
2' Purlins
4" CONCRETE Floor

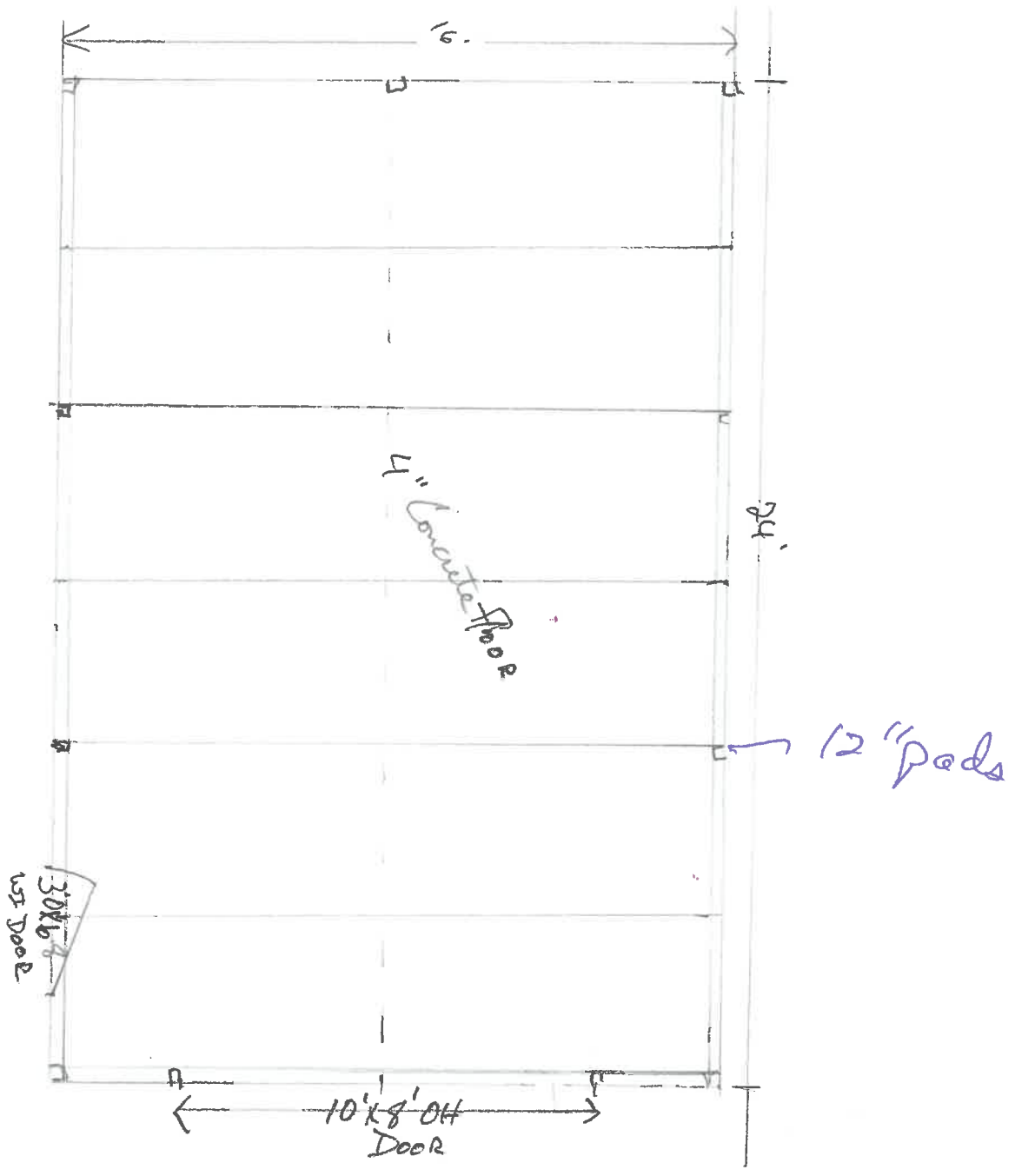

CASHIER: Please staple receipt to back.

SPECIAL ORDER CONTRACT

GUEST COPY

DEFIANCE Store #3170
 08845 STATE ROUTE 66 N Phone: 419-782-0436
 DEFIANCE, OH Fax: 419-782-5657

GUEST NAME-ADDRESS-PHONE

Dave Spangler
 11649 County Road K
 Napoleon, OH 435459536
 Phone: 4194382489

IMPORTANT

1. Verify quoted product and quantity
2. Product will be ordered upon payment
3. Track order on Menards.com
4. Pick up order within 14 days of arrival at store (N/A - Deliveries and Pickup at Plant)
5. Retain receipt

SOLD BY

ORDER DATE

TOMC

6/21/2017

EST. DELIVERY DATE NOT BINDING ON
 MENARDS INC. BASED ON PROMISES BY
 OTHERS.

7/4/2017

ADDITIONAL INFORMATION
 Delivered to DEFIANCE, OH Menards store.

QTY ORDERED	DESCRIPTION	SKU	UNIT PRICE	EXTENDED PRICE
7	16' 4/12 4' OC 20-4-0-1 Truss Type: Postframe Common Span: 16' O.C. Spacing: 4' Pitch: 4/12 Bottom Pitch: 0/12 Heel Height: 3" 15/16 Left Overhang: 1' Right Overhang: 1' Ground Snow Load: 20 Loading: 20-4-0-1	1004546	\$55.39	\$387.73

This is a quote valid today. This quote becomes an order only upon payment and a valid Menards receipt for this order is attached.

READ THIS CONTRACT CAREFULLY. The terms and conditions set forth in this document are a complete and final expression of the parties. The contract cannot be altered except by written instrument explicitly signed and executed by the General Manager. Any and all claims under this contract must be brought within one year of purchase. "Custom made" special order merchandise purchased from Menards is **NON-REFUNDABLE**. "Non-custom made" Special order product may be refunded at Menards sole discretion with a 25% restocking fee. Purchaser is responsible for providing to Menards all measurements, sizes, and colors stated above. Purchaser's exclusive remedy, if any product is defective or fails to conform to the terms of the contract, is replacement of the product. All defects and non-conformities must be reported to Menards within 3 days of receiving the product. Purchaser understands that all product is sold "AS IS" and the manufacturer's warranty, if any, is controlling. **MENARDS MAKES NO WARRANTIES, EXPRESS OR IMPLIED AS TO THE MERCHANTABILITY OR FITNESS FOR A PARTICULAR PURPOSE OF THE PRODUCT.** There are no representations that the products listed herein meet local, state, or federal code requirements. Menards liability shall not exceed the purchase price of the products sold. **MENARDS SHALL NOT BE LIABLE FOR ANY SPECIAL, INCIDENTAL, OR CONSEQUENTIAL DAMAGES.** Menards agrees to email Purchaser when the product is available for pick-up. If Purchaser fails to provide an email address, it is Purchaser's responsibility to check the status of the order by visiting Menards.com. If Purchaser refuses or fails to pick up the product within 14 days from the date of its availability, Menards may liquidate the product and shall be entitled to a 25% restocking fee. Menards may withhold any payment received as partial satisfaction. Purchaser agrees that Menards is not liable if the vendor, which supplies the product on this contract, fails to perform. Purchaser agrees that any and all controversies or claims arising out of or relating to this contract, or the breach thereof, shall be settled by binding arbitration administered by the American Arbitration Association under its applicable Consumer or Commercial Arbitration Rules. Purchaser agrees that all arbitrators selected shall be attorneys. This provision shall supersede any contrary rule or provision of the forum state. **YOUR PURCHASE OF THE PRODUCT ON THIS CONTRACT CONSTITUTES YOUR AGREEMENT TO ALL TERMS AND CONDITIONS STATED ABOVE.**

SUB-TOTAL: \$387.73
 SHIPPING CHARGES:
 PRE-TAX TOTAL: \$387.73
 VENDOR: MIDWEST MANUFACTURING

For the most accurate and up-to-date status of your order, please visit:

www.menards.com

If this is a partial pickup, please verify all quantities/items being signed for. Menards is not responsible for shortages after leaving the yard.

